

# ORDINANCE NO. 2019-08-01

**AN ORDINANCE OF THE CITY OF WESTON, COLLIN COUNTY, TEXAS, ALTERING THE PRIMA FACIE SPEED LIMITS ESTABLISHED FOR VEHICLES UNDER THE PROVISIONS OF TRANSPORTATION CODE, SECTION 545.356 UPON FARM TO MARKET HIGHWAY NO. 455 OR PARTS THEREOF, WITHIN THE INCORPORATE LIMITS OF THE CITY OF WESTON, AS SET OUT IN THIS ORDINANCE, AND PROVIDING A PENALTY OF A FINE NOT TO EXCEED TWO-HUNDRED DOLLARS (\$200.00) FOR THE VIOLATION OF THIS ORDINANCE; PROVIDING FOR CUMULATIVE REPEALER, SEVERABILITY, SAVINGS AND PUBLICATION CLAUSES; AND PROVIDING AN EFFECTIVE DATE.**

**WHEREAS**, Section 545.356 of the Texas Transportation Code, provides that whenever the governing body of the City shall determine upon the basis of an engineering and traffic investigation that any prima facie speed therein set forth is greater or less than is reasonable or safe under the conditions found to exist at any intersection or other place or upon any part of a street or highway within the city, taking into consideration the width and condition of the pavement and other circumstances on such portion of said street or highway, as well as the usual traffic thereon, said governing body may determine and declare a reasonable and safe prima facie speed limit thereat or thereon by the passage of an ordinance, which shall be effective when appropriate signs giving notice thereof are erected at such intersection or other place of part of the street or highway.

**NOW, THEREFORE, BE IT ORDAINED BY THE CITY COUNCIL OF THE CITY OF WESTON, TEXAS, THAT:**

## **SECTION 1 PRIMA FACIE SPEED LIMITS ESTABLISHED**

Upon the basis of an engineering and traffic investigation heretofore made as authorized by the provisions of Transportation Code, Section 545.356, the following prima facie speed limits hereafter indicated for vehicles on the attached Exhibit "A" (strip map) are hereby determined and declared to be reasonable and safe; and such speed limits are hereby fixed at the rate of speed indicated for vehicles traveling upon the named streets and highway, or parts thereof, described as follows:

A. That from and after the date of the passage of this speed zone ordinance, no motor vehicle shall be operated along and upon Farm to Market Highway No. 455 within the corporate limits of the City of Weston in excess of speeds now set forth in Exhibit "A".

## **SECTION 2 SIGNS AUTHORIZED**

The Mayor of the City of Weston is hereby authorized to cause to be erected, appropriate signs indicating such speed zones.

## **SECTION 3 PENALTY**

Any person, firm or corporation who shall violate any of the provisions of this article or who shall fail to comply with any provisions hereof shall be guilty of a misdemeanor and upon conviction, shall be subject to a fine not to exceed two-hundred dollars (\$200.00), and each day that such violation continues shall constitute a separate offense and shall be punishable accordingly.

## **SECTION 3 PUBLICATION IN OFFICIAL NEWSPAPER**

The City Secretary of the City of Weston is hereby directed to publish this ordinance or its caption and penalty in the official City newspaper as required by Section 52.011 of the Texas Local Government Code.

**ORDINANCE NO. 2019-08-01**

**SECTION 4  
CUMULATIVE REPEALER CLAUSE**

This Ordinance shall be cumulative of all other Ordinances and shall not repeal any of the provisions of such Ordinances except for those instances where there are direct conflicts with the provisions of this Ordinance. Ordinances, or parts thereof, in force at the time this Ordinance shall take effect and that are inconsistent with this Ordinance are hereby repealed to the extent that they are inconsistent with this Ordinance. Provided however, that any complaint, action, claim or lawsuit which has been initiated or has arisen under or pursuant to such other Ordinances on the date of adoption of this Ordinance shall continue to be governed by the provisions of such Ordinance and for that purpose the Ordinance shall remain in full force and effect

**SECTION 5  
PROVISIONS SEVERABLE**

It is hereby declared to be the intention of the City Council that the phrases, clauses, paragraphs and sections of this ordinance are severable, and if any phrase, clause, sentence, paragraph or section of this ordinance shall be declared unconstitutional by the valid judgment or decree of any court of competent jurisdiction, such unconstitutionality shall not affect any of the remaining phrases, clauses, sentences, paragraphs or sections of this ordinance, since the same would have been enacted by the City Council without the incorporation in this ordinance of any such unconstitutional phrase, clause, sentence, paragraph or section.

**SECTION 6  
SAVINGS CLAUSE**

All rights and remedies of the City of Weston are expressly saved as to any and all violations of the provisions of any ordinance that has accrued at the time of the effective date of this Ordinance; and, as to such accrued violations and all pending litigation, both civil and criminal, whether pending in court or not, under such ordinances, same shall not be affected by this Ordinance but may be prosecuted until final disposition by the courts.

**SECTION 7  
EFFECTIVE DATE**

This Ordinance shall be in full force and effect from and after its passage and publication as provided by law, and it is so ordained.

**PASSED AND APPROVED** by Council this, the 13<sup>th</sup> day of August, 2019.

APPROVE

Patti Harrington  
Patti Harrington, Mayor

ATTEST

Susan Coffey  
Susan Coffey, City Secretary

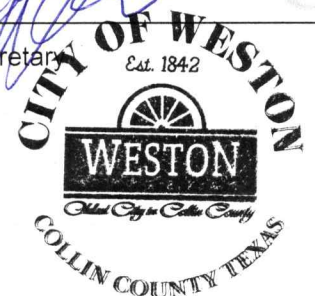

# FM 455

DEVELOPMENT  
RES. SIGHT DISTANCE  
BALL BANK OR ADVISORY SPEED  
CURVES OVER 2°  
GRADES OVER 3%  
SURFACE WIDTH AND TYPE  
R.O.W. AND ROBD. WIDTH  
ACCIDENTS  
ZONE LENGTHS (MILES)  
ZONE SPEEDS (M.P.H.)  
EXISTING SPEED LIMIT

OPEN  
1 LANE (NO SHOULDER, UNDIVIDED)

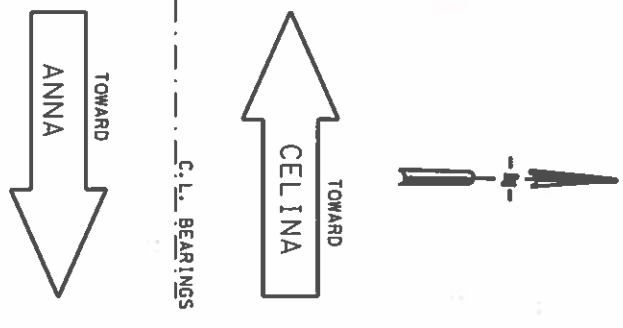

EXISTING SPEED LIMIT  
ZONE SPEEDS (M.P.H.)  
ZONE LENGTHS (MILES)  
ACCIDENTS  
R.O.W. AND ROBD. WIDTH  
SURFACE WIDTH AND TYPE  
GRADES OVER 3%  
CURVES OVER 2°  
BALL BANK OR ADVISORY SPEED  
RES. SIGHT DISTANCE  
DEVELOPMENT

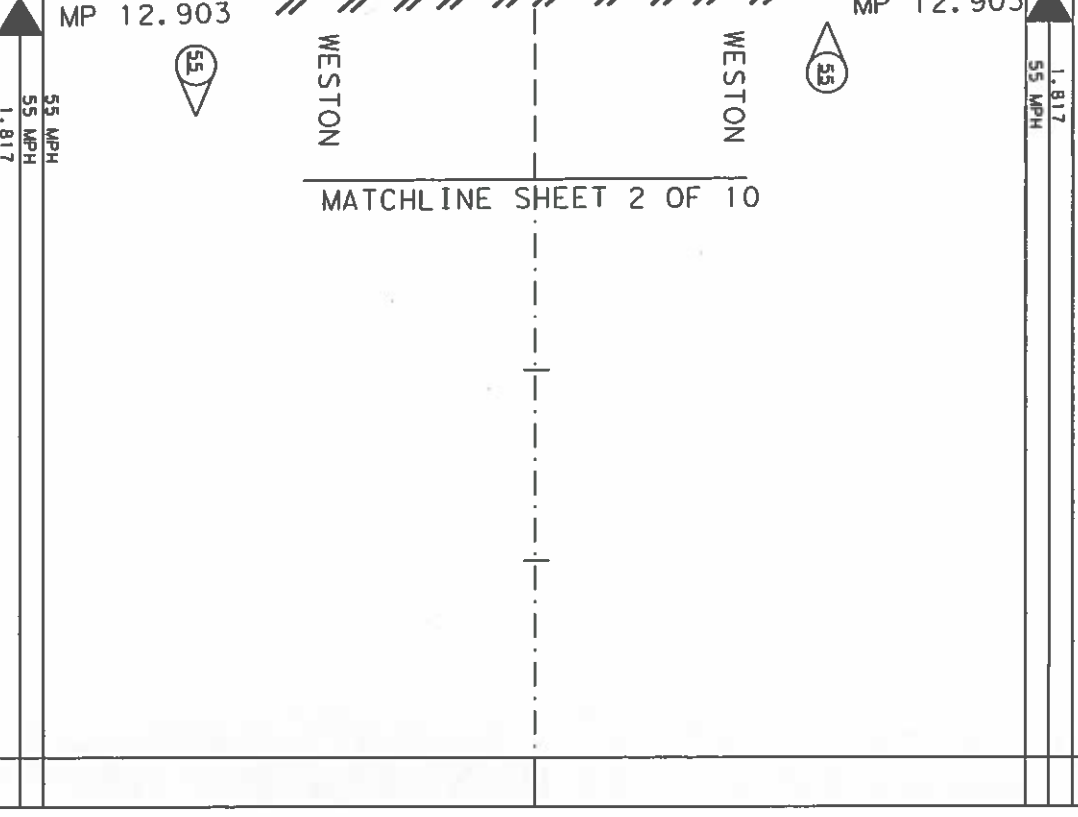
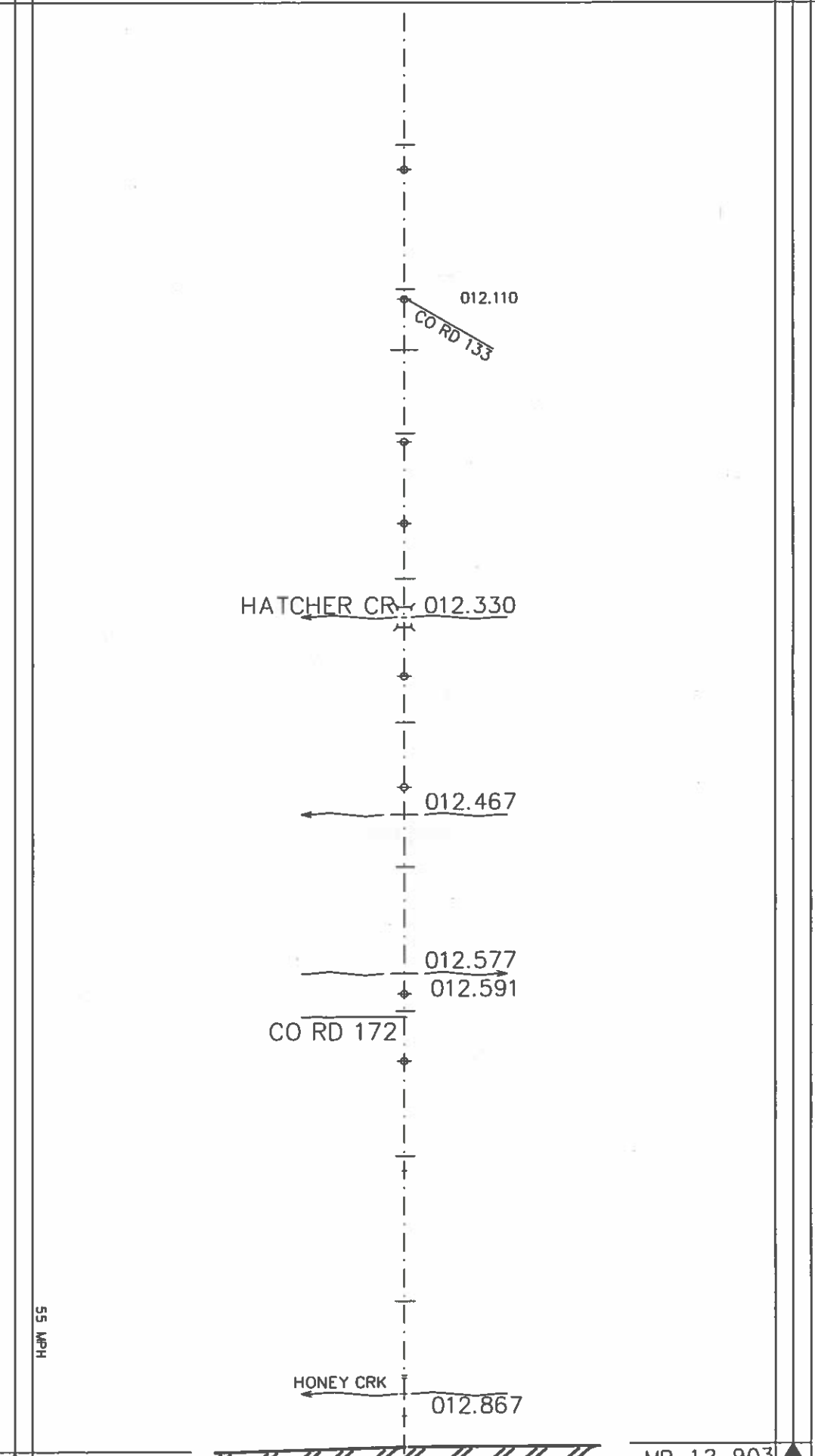

COUNTY: COLLIN  
CITY: WESTON  
SCALE 1" = 0.1 MILES  
DATE: / /  
REPLACES: / /  
REPLACED BY: / /  
CANCELLED BY: / /

MINUTE NO. :  
DATE: / /  
REPLACES: / /  
REPLACED BY: / /  
CANCELLED BY: / /

DISTRICT: DALLAS  
HIGHWAY: FM 455  
DATE OF STUDY 08-10-17  
SCALE 1" = 0.1 MILES  
LIMITS OF ZONE  
SECTION ONE LENGTH 0.748 MILES  
SECTION TWO LENGTH 0.436 MILES  
STA. OR M.P. CONT. AND SECT. PROJECT  
MP 12.903  
MP 17.091  
MP 13.445  
MP 17.527

## SPEED ZONE

CONT. 0816 SEC. 04

LIMITS: FROM HONEY CREEK  
TO EASTERN WESTON CITY LIMITS

- FATAL ACCIDENT
- PERSONAL INJURY ACCIDENT
- PROPERTY DAMAGE ACCIDENT
- INDICATES SECTION ZONED BY COMMISSION MINUTE
- ▲ SIGNALIZED INTERSECTION
- TRIAL RUN

SHEET 1 OF 5  
Texas Department of Transportation  
SPEED STUDY  
COLLIN COUNTY  
FM 455

SECTION	NO.	FEDERAL AID PROJECT NO.	SHEET NO.
STATE	DIST. NO.	COUNTY	
COUNTY	SECTION NO.	SECTION NO.	SECTION NO.
CHECKED			

DEVELOPMENT  
RES. SIGHT DISTANCE  
BALL BANK OR ADVISORY SPEED  
CURVES OVER 2"  
GRADES OVER 3%  
SURFACE WIDTH AND TYPE  
R.O.W. AND R.O.B.D. WIDTH  
ACCIDENTS  
ZONE LENGTHS (MILES)  
ZONE SPEEDS (M.P.H.)  
EXISTING SPEED LIMIT

OPEN  
1 LANE (NO SHOULDER, UNDIVIDED)  
1.817  
55 MPH

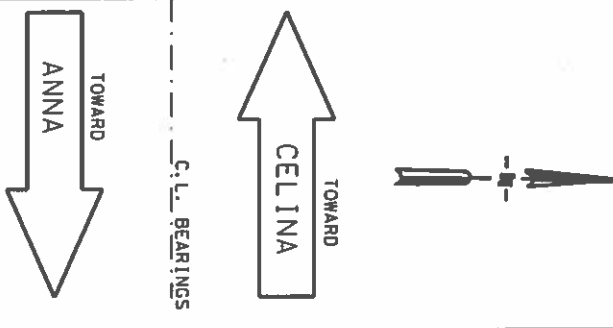

MATCHLINE SHEET 1 OF 10

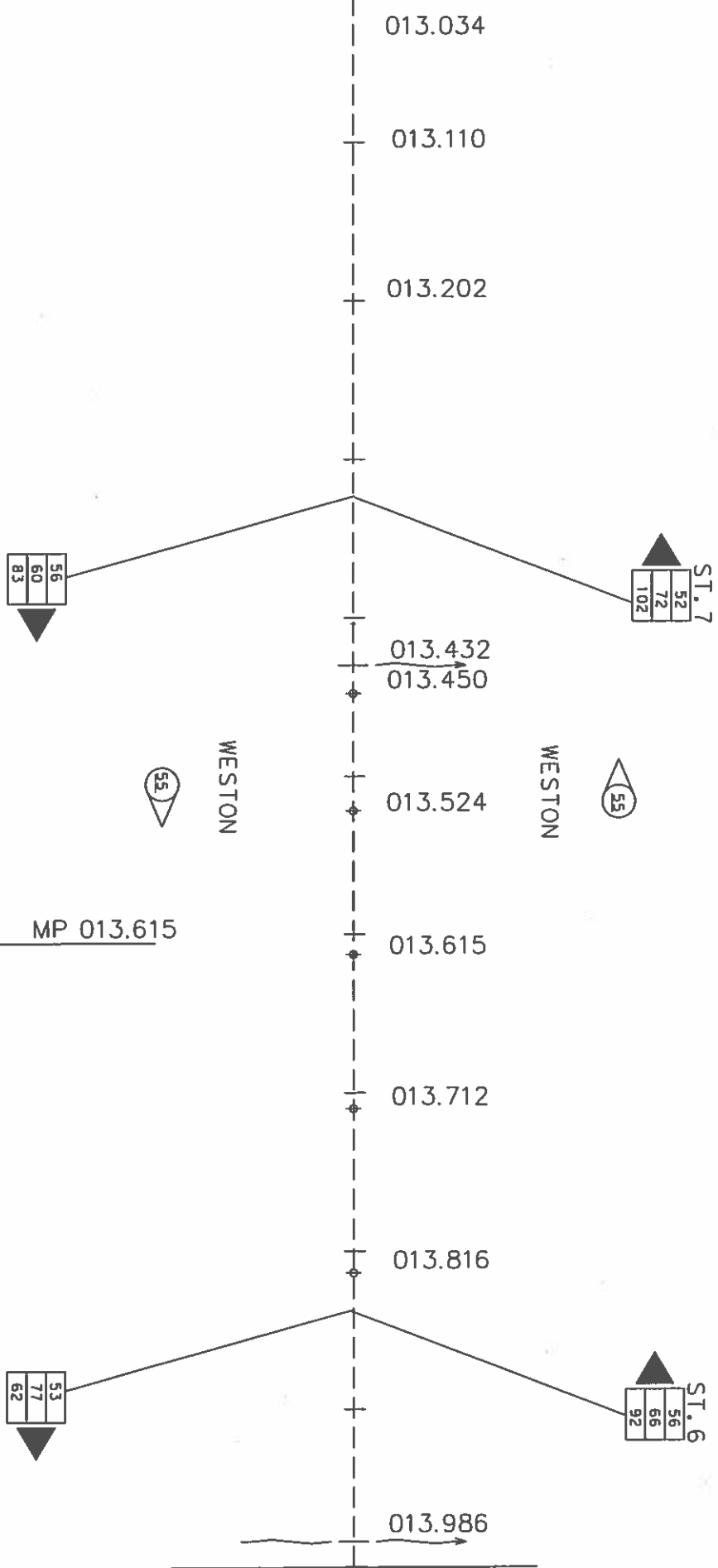

MATCHLINE SHEET 3 OF 10

EXISTING SPEED LIMIT  
ZONE SPEEDS (M.P.H.)  
ZONE LENGTHS (MILES)

55 MPH  
55 MPH  
1.817

ACCIDENTS  
R.O.W. AND R.O.B.D. WIDTH  
SURFACE WIDTH AND TYPE  
GRADES OVER 3%  
CURVES OVER 2"  
BALL BANK OR ADVISORY SPEED  
RES. SIGHT DISTANCE  
DEVELOPMENT

1 LANE (NO SHOULDER, UNDIVIDED)  
OPEN

DISTRICT: DALLAS  
HIGHWAY: FM 455  
DATE OF STUDY 08-10-17

COUNTY: COLLIN  
CITY: WESTON  
SCALE 1" = 0.1 MILES  
DATE / /  
REPLACES: / /  
CANCELLED BY: / /

SECTION ONE		LENGTH	MILES		SECTION TWO		LENGTH	MILES	
BEGINS	ENDS	MP	STA. OR M.P.	CONT. AND SECT.	PROJECT	BEGINS	ENDS	MP	STA. OR M.P.
0 + 00	0 + 00								

MINUTE NO. :  
REPLACES :  
CANCELLED BY :  
DATE / /  
DATE / /

LIMITS OF ZONE  
LIMITS: FROM HONEY CREEK TO EASTERN WESTON CITY LIMITS  
CONT. 0816 SEC. 04  
SPEED ZONE



LIMITS: FROM HONEY CREEK TO EASTERN WESTON CITY LIMITS

SHEET 2 OF 5  
Texas Department of Transportation  
SPEED STUDY  
COLLIN COUNTY  
FM 455

DESIGN TEAM	DATE	PROJECT NO.	SHEET NO.
STATE	COUNTY	SECTION	DATE
CHECKED	DATE	BY	NO.

DEVELOPMENT  
RES. SIGHT DISTANCE  
BALL BANK OR ADVISORY SPEED  
CURVES OVER 2°  
GRADES OVER 3%  
SURFACE WIDTH AND TYPE  
R.O.W. AND RDBD. WIDTH  
ACCIDENTS

OPEN  
1 LANE (NO SHOULDER, UNDIVIDED)  
55 MPH  
1.817  
55 MPH  
55 MPH

ST. 5  
61  
68  
81

ST. 4  
48  
69  
77

55 MPH  
1.409  
45 MPH

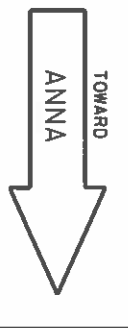
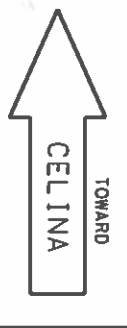

MATCHLINE SHEET 2 OF 10

MATCHLINE SHEET 4 OF 10

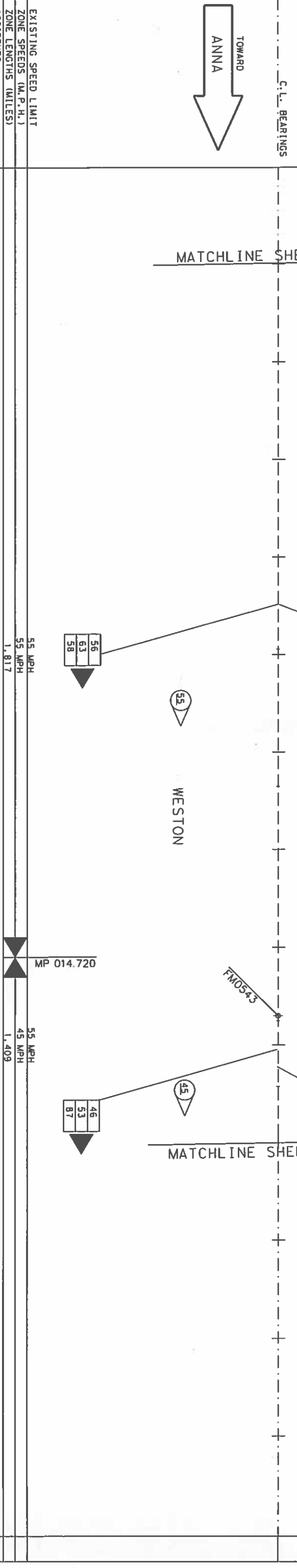

EXISTING SPEED LIMIT  
ZONE SPEEDS (M.P.H.)  
ZONE LENGTHS (MILES)  
ACCIDENTS  
R.O.W. AND RDBD. WIDTH  
SURFACE WIDTH AND TYPE  
GRADES OVER 3%  
CURVES OVER 2°  
BALL BANK OR ADVISORY SPEED  
RES. SIGHT DISTANCE  
DEVELOPMENT

55 MPH  
55 MPH  
1.817

55 MPH  
45 MPH  
1.409

1 LANE (NO SHOULDER, UNDIVIDED)  
OPEN

DISTRICT: DALLAS  
COUNTY: COLLIN  
CITY: WESTON  
HIGHWAY: FM 455  
DATE OF STUDY 08-10-17  
SCALE 1" = 0.1 MILES

MINUTE NO. :  
REPLACES :  
REPLACED BY :  
CANCELLED BY :

DATE / /  
DATE / /  
DATE / /  
DATE / /

SECTION ONE LENGTH MILES  
SECTION TWO LENGTH MILES  
STA. OR M.P. CONT. AND SECT. PROJECT  
STA. OR M.P. CONT. AND SECT. PROJECT

SECTION ONE	LENGTH	MILES	SECTION TWO	LENGTH	MILES
BEGINS	0 + 00		BEGINS		
ENDS	0 + 00		ENDS		

SECTION ONE	LENGTH	MILES	SECTION TWO	LENGTH	MILES
BEGINS	0 + 00		BEGINS		
ENDS	0 + 00		ENDS		

LIMITS OF ZONE  
LIMITS: FROM HONEY CREEK  
TO EASTERN WESTON CITY LIMITS

SPEED ZONE  
CONT. 0816 SEC. 04

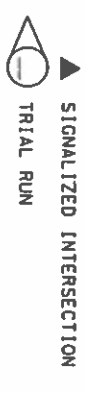

DESIGN TEAM  
STATE  
COUNTY  
SHEET NO.

TX. NO. FEDERAL AID PROJECT NO.  
SHEET NO.

DESIGNED BY  
CHECKED BY

DATE

PROJECT NO.

SECTION NO.

SHEET NO.

# FM 455

DEVELOPMENT  
RES. SIGHT DISTANCE  
BALL BANK OR ADVISORY SPEED  
CURVES OVER 2°  
GRADES OVER 3%  
SURFACE WIDTH AND TYPE  
R.O.W. AND ROBD. WIDTH  
ACCIDENTS

OPEN  
1 LANE (NO SHOULDER, UNDIVIDED)  
1.409  
45 MPH

EXISTING SPEED LIMIT  
ZONE SPEEDS (M.P.H.)  
ZONE LENGTHS (MILES)  
ACCIDENTS  
DATE  
REPLACES BY  
CANCELLED BY

MATCHLINE SHEET 3 OF 10

MATCHLINE SHEET 5 OF 10

SECTION ONE	LENGTH	MILES	SECTION TWO	LENGTH	MILES
BEGINS MP 0 + 00	CONT. AND SECT.	PROJECT	BEGINS MP	CONT. AND SECT.	PROJECT
ENDS MP 0 + 00	CONT. AND SECT.	PROJECT	ENDS MP	CONT. AND SECT.	PROJECT

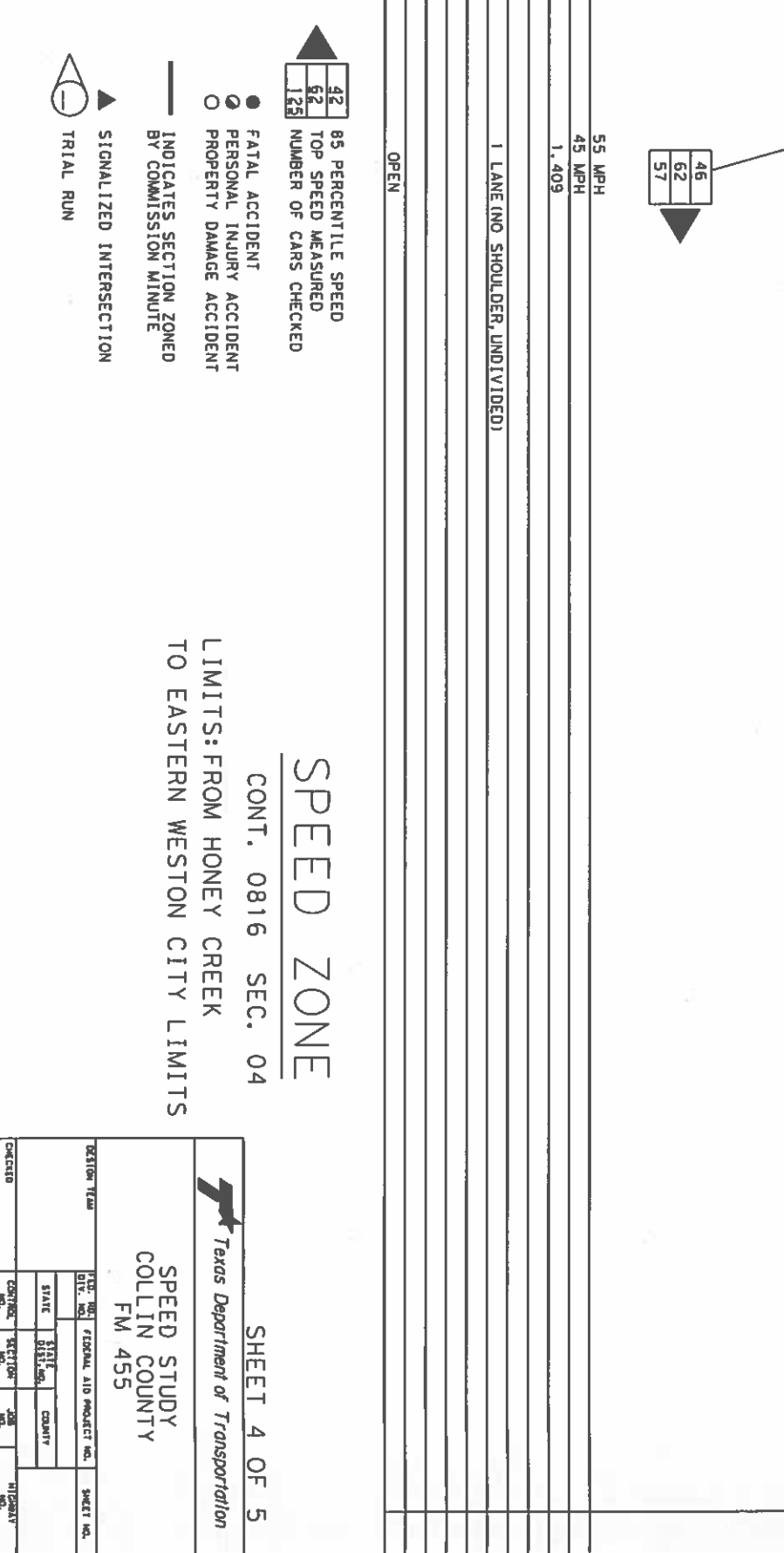

## SPEED ZONE

CONT. 0816 SEC. 04  
LIMITS: FROM HONEY CREEK  
TO EASTERN WESTON CITY LIMITS

SHEET 4 OF 5  
Texas Department of Transportation  
SPEED STUDY  
COLLIN COUNTY  
FM 455

DESIGN TEAM	DATE	PROJECT NO.	SHEET NO.
STATE	COUNTY	SECTION	DATE
CITY	SECTION	DATE	DATE

# FM 455

DEVELOPMENT	RES. SIGHT DISTANCE	OPEN
BALL BANK OR ADVISORY SPEED		
CURVES OVER 2°		
GRADES OVER 3%		
SURFACE WIDTH AND TYPE		
R.O.W. AND ROBD. WIDTH		
ACCIDENTS		
ZONE LENGTHS (MILES)	1.409	0.616
ZONE SPEEDS (M.P.H.)	45 MPH	55 MPH
EXISTING SPEED LIMIT		

MATCHLINE SHEET 4 OF 10

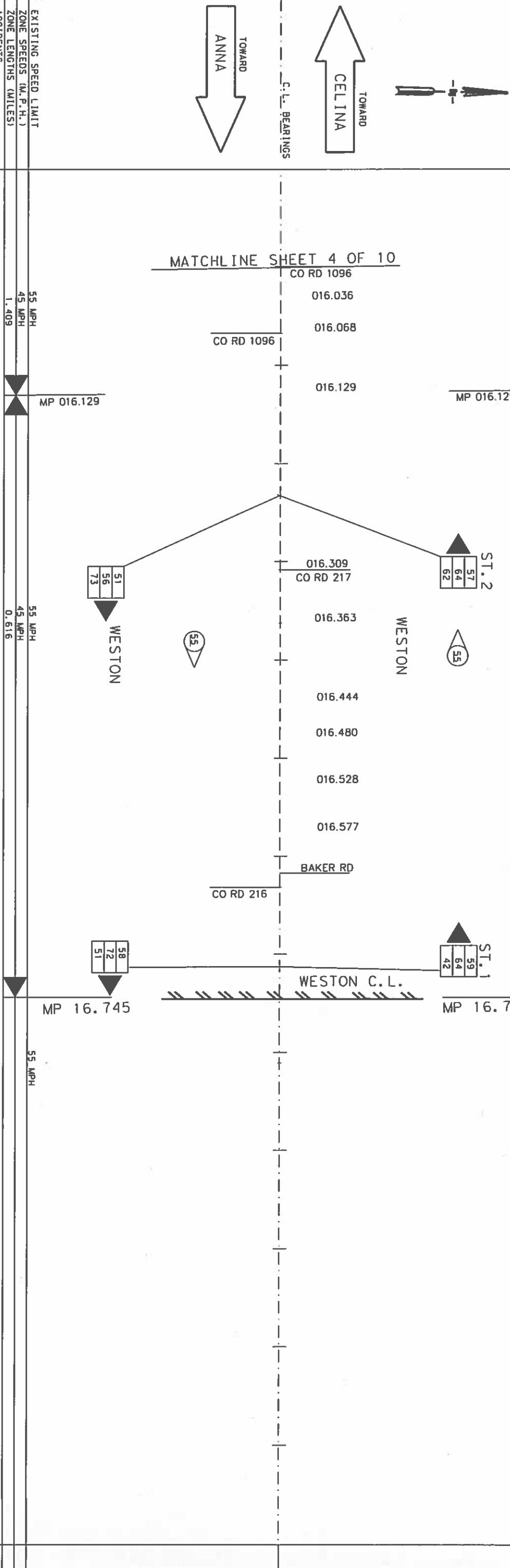

EXISTING SPEED LIMIT	55 MPH
ZONE SPEEDS (M.P.H.)	45 MPH
ZONE LENGTHS (MILES)	1.409
ACCIDENTS	
R.O.W. AND ROBD. WIDTH	
SURFACE WIDTH AND TYPE	
GRADES OVER 3%	
CURVES OVER 2°	
BALL BANK OR ADVISORY SPEED	
RES. SIGHT DISTANCE	
DEVELOPMENT	OPEN

DISTRICT: DALLAS	COUNTY: COLLIN	MINUTE NO.:	DATE: / /
HIGHWAY: FM 455	CITY: WESTON	REPLACES:	DATE: / /
DATE OF STUDY 08-10-17	SCALE 1" = 0.1 MILES	REPLACED BY:	DATE: / /
		CANCELLED BY:	DATE: / /

LIMITS OF ZONE			
SECTION ONE	LENGTH	MILES	SECTION TWO
STA. OR M.P.	CONT. AND SECT.	PROJECT	STA. OR M.P.
BEGINS			BEGINS
ENDS			ENDS

## SPEED ZONE

CONT. 0816 SEC. 04

LIMITS: FROM HONEY CREEK TO EASTERN WESTON CITY LIMITS



SPEED STUDY  
COLLIN COUNTY  
FM 455

SHEET 5 OF 5

DESIGN TEAM	DATE	PROJECT NO.	SHEET NO.
STATE	COUNTY		
CHECKED	SECTION	NO.	NO.

- FATAL ACCIDENT
- PERSONAL INJURY ACCIDENT
- PROPERTY DAMAGE ACCIDENT
- INDICATES SECTION ZONED BY COMMISSION MINUTE
- ▲ SIGNALIZED INTERSECTION
- TRIAL RUN

42	85 PERCENTILE SPEED
62	TOP SPEED MEASURED
125	NUMBER OF CARS CHECKED